



Brass Inserts for Plastics

Brass

Self Colour

RoHS 2 Compliant

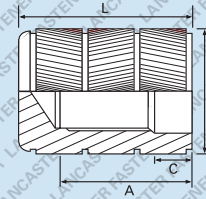
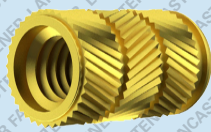

Further technical data is available on page 266

Unheaded (UHDFLOFIX)

Thread	M2*	M2.5*	M3	M3.5	M4	M5	M6	M8*	M10*	Thread
W mm	3.4	4.3	4.7	5.5	6.3	7.3	9.8	11.4	13.8	W mm
A min mm	3.6	4.0	4.6	6.0	6.7	7.4	8.1	11.1	11.9	A min mm
C mm	1.0	1.2	1.3	1.6	1.8	2.0	2.0	2.3	2.4	C mm
L- Length mm	Bulk Carton Quantity Small Box Quantity Weight (KG) per 1,000									L- Length mm
5.5	N/A 1,000 0.19									5.5
6.4		N/A 1,000 0.24								6.4
7.3			25,000 1,000 0.45							7.3
9.2										9.2
10.2					10,000 1,000 1.39					10.2
11.2						10,000 1,000 2.08				11.2
14.4							2,500 500 5.26			14.4
16.5								N/A 500 7.60		16.5
17.9									N/A 500 8.70	17.9
-										-
-										-
-										-
-										-
-										-
-										-

Brass Self Colour - preferred and available from stock.

PRODUCT CODE EXAMPLE

IPMUHDFLOFIX060BRSC

PRODUCT DESCRIPTION EXAMPLE

M6 Unheaded Flow-Fix Brass Inserts for Plastics Self Colour

*Non preferred. UNC & UNF thread sizes available to order. Contact our sales team to enquire for availability. E. & O. E.

© 2021, Lancaster Fastener Co Ltd. All images are copyright protected.