

Round

Steel / Self Colour

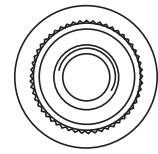

Thread	M2.5	M3	M3.5	M4	M5	M6	M8	M10	M12	Thread
A Dia. of spigot +0.00 -0.13	5.54	5.54	6.73	6.73	7.92	9.52	12.70	15.87	19.05	A Dia. of spigot +0.00 -0.13
B Dia. of body ±0.15	7.92	7.92	9.52	9.52	11.10	12.70	15.87	19.05	25.40	B Dia. of body ±0.15
C Depth of body ±0.13	3.17	3.17	3.17	3.17	3.81	5.08	6.35	7.62	10.16	C Depth of body ±0.13
Recom. Hole Size +0.05 -0.00	5.54	5.54	6.73	6.73	7.92	9.52	12.70	15.87	19.05	Recom. Hole Size +0.05 -0.00

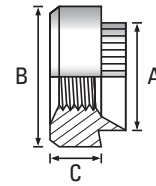

Scan the QR Code to view technical drawings for this product range
<https://www.lancasterfastener.com/drawings-hcrrbstsc>

GAUGE										GAUGE
10 swg					●	●	●	●		10 swg
12 swg						●	●			12 swg
14 swg				●		●	●	●	●	14 swg
16 swg					●	●	●			16 swg
18 swg				●		●	●	●		18 swg
20 swg						●				20 swg
-										-
-										-
-										-
-										-

● Steel / Self Colour - preferred and available from stock.

PRODUCT CODE EXAMPLE
HCRRB06010STSC

PRODUCT DESCRIPTION EXAMPLE
M6 x 10 swg Round Rivet Bush Steel / Self Colour

Screws for Plastics
 ISO & DIN 7500 Tap-Fix® Screws
 Machine Screws
 Self-Tapping Screws
 Self-Drilling Screws
 Micro Diameter Screws
 Hammer Drive Screws
 K-Series® Setzmuttern
 Rivet Bushes
 Self-Clinching Fasteners
 CD Weld Studs
 Brass Inserts for Plastics