



LANCASTER

DIN EN ISO 13918

CD Weld Studs

Internally Threaded

Copper Coated

RoHS 2 Compliant

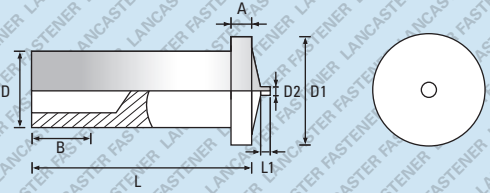

TYPE IT

Further technical data is available on page 262

Thread	M3	M4	M5	Thread
D ±0.1	5	6	7.1	D ±0.1
D1 ±0.2	6.5	7.5	9	D1 ±0.2
A	0.8 - 1.4	0.8 - 1.4	0.8 - 1.4	A
B +0.5 -0	5	6	7.5	B +0.5 -0
D2 ±0.6	0.75	0.75	0.75	D2 ±0.6
L1 ±0.5	0.8	0.8	0.85	L1 ±0.5
L- Length mm	Bulk Carton Quantity Small Box Quantity Weight (KG) per 1,000			L- Length mm
6	30,000 1,000 0.84			6
8	30,000 1,000 1.07	20,000 1,000 1.30		8
10	25,000 1,000 1.33	15,000 1,000 1.57	10,000 500 1.90	10
12	20,000 1,000 1.59	12,000 1,000 2.32	8,000 500 2.60	12
15	15,000 1,000 2.00	5,000 500 3.10	5,000 500 3.60	15
20	12,000 1,000 2.91	5,000 500 3.70	5,000 500 5.30	20
25		5,000 500 4.88	4,000 250 6.45	25
30				30
-				-
-				-
-				-
-				-
-				-

Copper Coated - preferred and available from stock.

PRODUCT CODE EXAMPLE

CDWSIT30025CU

PRODUCT DESCRIPTION EXAMPLE

M3 x 25 DIN EN ISO 13918 Type IT CD Weld Stud Copper Coated

E. & O. E.

© 2021, Lancaster Fastener Co Ltd. All images are copyright protected.