

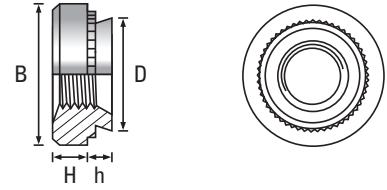

Nuts

Steel / Zinc Plated (CR3)



Thread	M2.5			M3			M3 Alt			M3.5			M4			M5			M6			M8		M10		Thread
	-0	-1	-2	-0	-1	-2	-0	-1	-2	-0	-1	-2	-0	-1	-2	-0	-1	-2	-0	-1	-2	-1	-2	-1	-2	
h _{max}	0.77	0.97	1.38	0.76	0.97	1.37	0.76	0.97	1.37	0.76	0.97	1.37	0.76	0.97	1.37	0.76	0.97	1.37	0.97	1.37	2.21	1.37	2.21	2.21	3.05	h _{max}
Min. Rec. sheet thickness	0.8	1.0	1.4	0.8	1.0	1.4	0.8	1.0	1.4	0.8	1.0	1.4	0.8	1.0	1.4	0.8	1.0	1.4	1.0	1.4	2.3	1.4	2.3	2.31	3.18	Min. Rec. sheet thickness
D _{Max}	4.22			4.22			4.73			4.73			5.38			6.38			8.72			10.44		13.97		D _{Max}
B _{±0.25}	6.30			6.30			7.10			7.10			7.90			8.70			11.05			12.65		17.35		B _{±0.25}
H _{±0.25}	1.50			1.50			1.50			1.50			2.00			2.00			4.10			5.50		7.48		H _{±0.25}
Hole Size +0.08 -0.00	4.25			4.25			4.75			4.75			5.40			6.40			8.75			10.50		14.00		Hole Size +0.08 -0.00
Min. distance to sheet edge	4.80			4.80			5.60			5.60			6.90			7.10			8.60			9.70		13.50		Min. distance to sheet edge

CODE	 <p>Scan the QR Code to view technical drawings for this product range https://www.lancasterfastener.com/drawings-hcnstzc</p>																								CODE
------	--	--	--	--	--	--	--	--	--	--	--	--	--	--	--	--	--	--	--	--	--	--	--	--	------

-0	●			●											●											●	-0		
-1		●			●										●											●	●	●	-1
-2			●			●									●											●	●	●	-2
-3																													-3
-																													-

● Steel / Zinc Plated (CR3) - preferred and available from stock.

PRODUCT CODE EXAMPLE
HCN04-1STZC

PRODUCT DESCRIPTION EXAMPLE
M4 x -1 Clinch Nut Steel / Zinc Plated (CR3)