

# Self-Tapping Screws

Screws for Sheet Metal Applications

T-Drive® (6-Lobe) Pan DIN 7981 Type F

Steel / Zinc Plated (CR3)

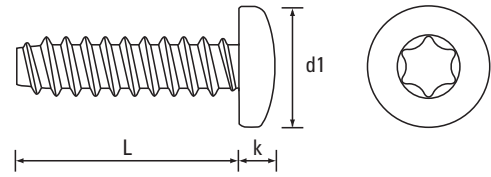
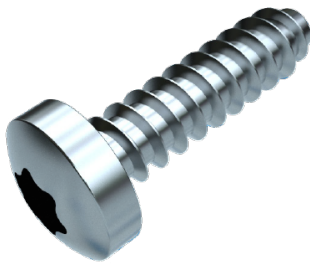

Dia. mm	2.2	2.9	3.5	3.9	4.2	4.8	5.5	6.3	Dia. mm
Dia. Gauge	2	4	6	7	8	10	12	14	Dia. Gauge
d1 - max	4.20	5.60	6.90	7.50	8.20	9.50	10.80	12.50	d1 - max
k - max	1.80	2.20	2.60	2.80	3.05	3.55	3.95	4.55	k - max
s - A/F	-	-	-	-	-	-	-	-	s - A/F
Recess	T8	T10	T15	T15	T20	T25	T25	T30	Recess

L - Length mm	 <p>Scan the QR Code to view technical drawings for this product range  <a href="https://www.lancasterfastener.com/drawings-for-ltbtspanzc">https://www.lancasterfastener.com/drawings-for-ltbtspanzc</a></p>								L - Length ins
4.5									3/16
6.5		●	●		●				1/4
8									5/16
9.5		●	●		●	●			3/8
13			●		●	●	●		1/2
16					●	●			5/8
19									3/4
22									7/8
25									1
32									1 1/4
38									1 1/2
45									1 3/4
50									2
57									2 1/4
63									2 1/2
70									2 3/4
75									3

● Steel / Zinc Plated (CR3) - preferred and available from stock.

PRODUCT CODE EXAMPLE  
LTBTXPAN55130ZC

PRODUCT DESCRIPTION EXAMPLE  
5.5 x 13.0 T-Drive® (6-Lobe) Pan DIN 7981 Type F Self-Tapping Screw Steel / Zinc Plated (CR3)

Screws for Plastics  
 ISO & DIN 7500 Tap-Fix® Screws  
 Machine Screws  
 Self-Tapping Screws  
 Self-Drilling Screws  
 Micro Diameter Screws  
 Hammer Drive Screws  
 K-Series® Setzmuttern  
 Rivet Bushes  
 Self-Dinching Fasteners  
 CD Weld Studs  
 Brass Inserts for Plastics