



LANCASTER

DIN EN ISO 13918

CD Weld Studs

Threaded
Copper Coated

RoHS 2 Compliant

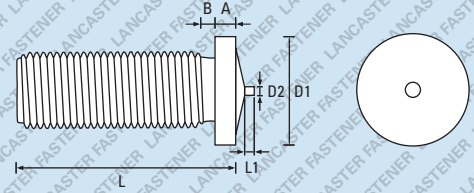

Also available in A2 Stainless Steel - See page 214

Further technical data is available on page 261

TYPE PT

Thread	M3	M4	M5	M6	M8	Thread
D1 ± 0.2	4.5	5.5	6.5	7.5	9.0	D1 ± 0.2
A	0.7 - 1.4	0.7 - 1.4	0.8 - 1.4	0.8 - 1.4	0.8 - 1.4	A
B max	1.5	1.5	2.0	2.0	3.0	B max
D2 ± 0.8	0.60	0.65	0.75	0.75	0.75	D2 ± 0.8
L1 ± 0.5	0.55	0.55	0.80	0.80	0.85	L1 ± 0.5
L- Length mm	Bulk Carton Quantity Small Box Quantity Weight (KG) per 1,000				L- Length mm	
6	40,000 1,000 0.32	20,000 1,000 0.60				6
8	40,000 1,000 0.37	20,000 1,000 0.73	15,000 500 1.15	12,000 500 1.60		8
10	25,000 1,000 0.46	20,000 1,000 0.90	12,000 500 1.31	10,000 500 1.85	4,000 200 3.32	10
12	25,000 1,000 0.54	15,000 1,000 0.98	10,000 500 1.57	8,000 500 2.22	3,000 200 3.75	12
15	25,000 1,000 0.69	15,000 1,000 1.23	10,000 500 1.90	6,000 250 2.89	3,000 200 5.00	15
16	20,000 1,000 0.76	15,000 500 1.25	8,000 500 2.20	6,000 250 2.90	3,000 200 5.56	16
20	15,000 1,000 0.90	10,000 500 1.50	6,000 500 2.50	5,000 250 3.50	2,000 100 6.40	20
25	10,000 1,000 1.09	5,000 500 1.92	5,000 250 3.13	4,000 250 4.54	2,000 100 8.00	25
30	7,000 1,000 1.44	5,000 500 2.35	3,000 250 3.74	3,000 250 5.22	2,000 100 9.40	30
35		5,000 500 2.69	3,000 250 4.39	3,000 250 6.25	2,000 100 10.80	35
40		3,000 500 3.05	2,000 250 5.00	2,000 250 7.00	1,500 100 12.34	40
45				1,500 250 7.80	1,500 100 14.26	45
50			1,000 250 6.41	1,000 250 8.50	1,000 100 15.96	50
55					1,000 100 17.56	55
60					1,100 100 19.12	60

Copper Coated - preferred and available from stock.

PRODUCT CODE EXAMPLE

CDWSPT50016CU

PRODUCT DESCRIPTION EXAMPLE

M5 x 16 DIN EN ISO 13918 Type PT CD Weld Stud Copper Coated

E. & O. E.

© 2021, Lancaster Fastener Co Ltd. All images are copyright protected.

Carbon Steel Product Ranges

Stainless Steel Product Ranges

Brass Product Ranges

Technical Data



CD Weld Studs

Internally Threaded

Copper Coated

RoHS 2 Compliant

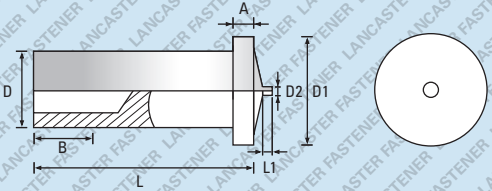

TYPE IT

Further technical data is available on page 262

Thread	M3	M4	M5	Thread
D ±0.1	5	6	7.1	D ±0.1
D1 ±0.2	6.5	7.5	9	D1 ±0.2
A	0.8 - 1.4	0.8 - 1.4	0.8 - 1.4	A
B +0.5 -0	5	6	7.5	B +0.5 -0
D2 ±0.6	0.75	0.75	0.75	D2 ±0.6
L1 ±0.5	0.8	0.8	0.85	L1 ±0.5
L- Length mm	Bulk Carton Quantity Small Box Quantity Weight (KG) per 1,000			L- Length mm
6	30,000 1,000 0.84			6
8	30,000 1,000 1.07	20,000 1,000 1.30		8
10	25,000 1,000 1.33	15,000 1,000 1.57	10,000 500 1.90	10
12	20,000 1,000 1.59	12,000 1,000 2.32	8,000 500 2.60	12
15	15,000 1,000 2.00	5,000 500 3.10	5,000 500 3.60	15
20	12,000 1,000 2.91	5,000 500 3.70	5,000 500 5.30	20
25		5,000 500 4.88	4,000 250 6.45	25
30				30
-				-
-				-
-				-
-				-
-				-
-				-
-				-

Copper Coated - preferred and available from stock.

PRODUCT CODE EXAMPLE

CDWSIT30025CU

PRODUCT DESCRIPTION EXAMPLE

M3 x 25 DIN EN ISO 13918 Type IT CD Weld Stud Copper Coated



LANCASTER

DIN EN ISO 13918

CD Weld Studs

Threaded
Aluminium

RoHS 2 Compliant

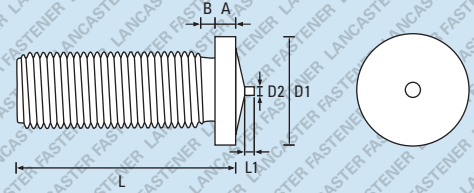

Also available in A2 Stainless Steel - See page 214

Further technical data is available on page 261

TYPE PT

Thread	M3	M4	M5	M6	M8	Thread
D1 ± 0.2	4.5	5.5	6.5	7.5	9.0	D1 ± 0.2
A	0.7 - 1.4	0.7 - 1.4	0.8 - 1.4	0.8 - 1.4	0.8 - 1.4	A
B max	1.5	1.5	2.0	2.0	3.0	B max
D2 ± 0.8	0.60	0.65	0.75	0.75	0.75	D2 ± 0.8
L1 ± 0.5	0.55	0.55	0.80	0.80	0.85	L1 ± 0.5
L- Length mm	Bulk Carton Quantity Small Box Quantity Weight (KG) per 1,000				L- Length mm	
6	40,000 1,000 0.10	20,000 1,000 0.19				6
8	40,000 1,000 0.14	20,000 1,000 0.23	15,000 500 0.36			8
10	25,000 1,000 0.17	20,000 1,000 0.29	12,000 500 0.45	10,000 500 0.63		10
12	25,000 1,000 0.20	15,000 1,000 0.35	10,000 500 0.54	8,000 500 0.76		12
15	25,000 1,000 0.25	15,000 1,000 0.40	10,000 500 0.67	6,000 250 0.83		15
16	20,000 1,000 0.28	15,000 500 0.50	8,000 500 0.68	6,000 250 1.00		16
20	15,000 1,000 0.31	10,000 500 0.57	6,000 500 0.90	5,000 250 1.26		20
25	10,000 1,000 0.39	5,000 500 0.60	5,000 250 1.05	4,000 250 1.53		25
30	7,000 1,000 0.47	5,000 500 0.80	3,000 250 1.20	3,000 250 1.84		30
35		5,000 500 0.92	3,000 250 1.51	3,000 250 2.13		35
40						40
45						45
50						50
55						55
60						60

Aluminium - preferred and available from stock.

PRODUCT CODE EXAMPLE

CDWSPT60025AL

PRODUCT DESCRIPTION EXAMPLE

M6 x 25 DIN EN ISO 13918 Type PT CD Weld Stud Aluminium Alloy

E. & O. E.

© 2021, Lancaster Fastener Co Ltd. All images are copyright protected.

t: +44 (0) 1524 389 232

f: +44 (0) 1524 66367

enquiries@lancasterfastener.co.uk

www.lancasterfastener.com