

Rivet Bushes

Fasteners for Sheet Metal Applications

Round

A2 Stainless Steel

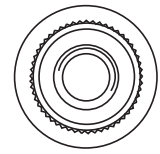
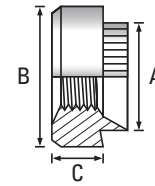

Thread	M2.5	M3	M3.5	M4	M5	M6	M8	M10	M12	Thread
A Dia. of spigot +0.00 -0.13	5.54	5.54	6.73	6.73	7.92	9.52	12.70	15.87	19.05	A Dia. of spigot +0.00 -0.13
B Dia. of body ±0.15	7.92	7.92	9.52	9.52	11.10	12.70	15.87	19.05	25.40	B Dia. of body ±0.15
C Depth of body ±0.13	3.17	3.17	3.17	3.17	3.81	5.08	6.35	7.62	10.16	C Depth of body ±0.13
Recom. Hole Size +0.05 -0.00	5.54	5.54	6.73	6.73	7.92	9.52	12.70	15.87	19.05	Recom. Hole Size +0.05 -0.00

GAUGE



Scan the QR Code to view technical drawings for this product range
<https://www.lancasterfastener.com/drawings-for-hcrrba2>

GAUGE

10 swg				●	●	●	●			10 swg
12 swg				●	●	●	●			12 swg
14 swg		●		●	●		●			14 swg
16 swg		●		●	●	●	●			16 swg
18 swg		●		●	●	●				18 swg
20 swg					●	●				20 swg
-										-
-										-
-										-
-										-

● A2 Stainless Steel - preferred and available from stock.

PRODUCT CODE EXAMPLE
 HCRRB05012A2

PRODUCT DESCRIPTION EXAMPLE
 M5 x 12 swg Round Rivet Bush A2 Stainless Steel